

MICDRAIN[®]-COMBO

Electronic timer controlled condensate drain

PRODUCT FEATURES

The MICDRAIN[®]-COMBO is the economy line compact draining solution for all your compressed air applications (dryers, filters, receivers, drip legs, after-coolers etc.).

The MICDRAIN[®]-COMBO removes condensate from compressed air systems by using a solenoid valve, with integrated ball-valve and strainer, in combination with an electronic timer.

Adjustable potentiometers allow the drain to be adjusted to suit any size compressed air system.

The LED display allows for visual confirmation of the operating status.

The TEST-feature enables you to discharge condensate manually and to check the valve operation.



COMMERCIAL BENEFITS

- Competitive solution suitable for any type or size of compressed air system.
- Successful draining of condensate due to large orifice (also heavily emulsified condensate).
- Sold only to OEM's and larger distributors.
- Low stocking cost advantages for you.
- Low purchase threshold for your customers.
- CE approved.
- Service kits available.

TECHNICAL ADVANTAGES

- Compact design and fully serviceable.
- LED-display for visual monitoring of the operating status.
- Direct acting valve with stainless steel operating parts, for a reliable discharge.
- FPM valve seal and a large 4.0 mm orifice.
- Incredibly simple to install and impossible to air lock.
- Fully automatic and 100% continuous duty.
- Integrated ball-valve and strainer and dual inlet 1/2" + 1/4".
- Operating pressure 0 to 16 bar.

**One size
fits all**

Opportunity:

Timer drains that have a smaller valve orifice than 4 mm that are fitted to compressors, dryers and receivers can easily be blocked (rust, scale etc.). The MICDRAIN-COMBO offers a low cost solution to improve the reliability factor with its highly reliable internal valve construction.

MICDRAIN®-COMBO

Electronic timer controlled condensate drain

DIMENSIONS (mm)

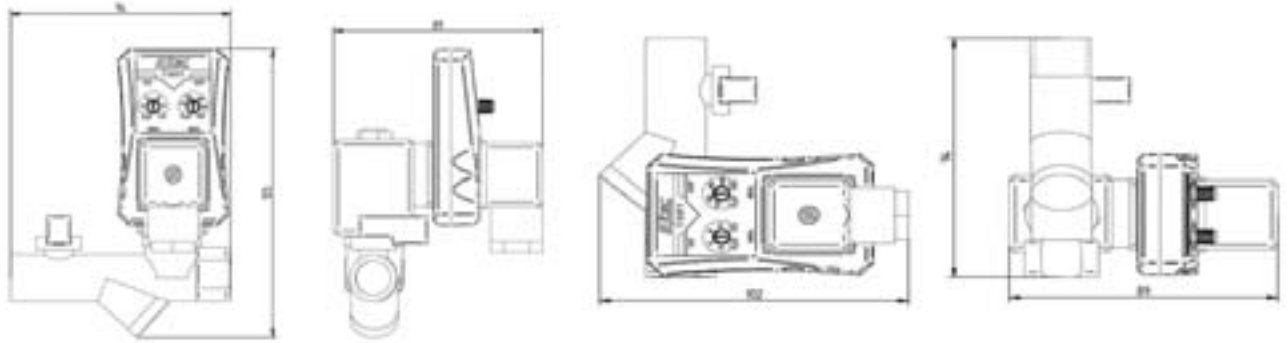

SPECIFICATIONS

TIMER DRAIN

Discharge time	0.5 – 10 sec., adjustable *
Pause time	0.5 – 45 min., adjustable *
Voltage	230VAC and 115VAC *
Maximum pressure	16 Bar g *
Inlet / outlet connection	1/2" + 1/4" (dual) / 1/2" *
Valve type	2/2 way valve (direct acting)
Orifice	4.0 mm
Valve seal	FPM
Operating parts	Stainless steel
Integrated ball valve and strainer	Yes
Environmental protection	IP65 (NEMA 4)



Compact solution



Dual inlet design

* For other requests/specifications please see FLUIDRAIN or EZ1 ranges.

INSTALLATION OPTIONS



Integrated strainer with filter

JORC IS ISO 9001:2008 CERTIFIED



Information provided herewith is believed to be accurate and reliable. However, no responsibility is assumed for its use or for any infringement of patents or rights of others, which may result from its use. In addition, the manufacturer reserves the right to revise information without notice and without incurring any obligation.

JORC Industrial BV
 Pretoriastraat 28
 NL-6413 NN Heerlen
 The Netherlands

Tel +31 45 524 24 27
 Fax +31 45 524 19 79
 E-mail info@jorc.nl
[http:// www.jorc.eu](http://www.jorc.eu)